

**Corporation of the Town of Petawawa**

**By-law 1664/24**

**Being a By-law to Amend By-law 1597/23,  
Being a By-law to Regulate and Govern the Operation of All-Terrain, Multi-  
Purpose and Recreational Off-Road Vehicles (ORVs) on Highways Under the  
Jurisdiction of the Corporation of the Town of Petawawa**

**Whereas** Section 11 (1) of the *Municipal Act*, 2001, S.O. 2001, c. 25, as amended, authorizes lower-tier municipalities to provide any service or thing that the municipality considers necessary or desirable for the public;

**And Whereas** Section 11 (3) of the *Municipal Act*, 2001, S.O. 2001, c.25, as amended, provides that a municipality may pass by-laws with respect to municipally owned roads, including parking and traffic on such highways;

**And Whereas** Section 191.8(1) of the *Highway Traffic Act*, R.S.O. 1990, c. H.8, as amended, provides that no person shall drive an off-road vehicle on a highway except in accordance with the *Highway Traffic Act* regulations and any applicable Municipal By-law;

**And Whereas** Section 191.8(3) of the *Highway Traffic Act*, R.S.O. 1990. c. H.8, as amended, provides that a municipality may pass by-laws permitting certain off-road vehicles on highways under the jurisdiction of the municipality and providing speed limits for such vehicles;

**And Whereas** *Ontario Regulation 316/03: Operation of Off-Road Vehicles on Highways*, made under the *Highway Traffic Act*, R.S.O. 1990. c. H.8, as amended, defines an All-Terrain Vehicle and provides regulations governing the operation of All-Terrain Vehicles upon Highways;

**And Whereas** the operation of off-road vehicles on highways is a privilege and not a right;

**And Whereas** the Renfrew County ATV Club submitted a request to Council to expand the designated routes to permit off-road vehicle operation on municipally owned highways;

**And Whereas** Council of the Corporation of the Town of Petawawa is desirous of expanding the designated routes permitting off-road vehicle access to certain roads under its municipal jurisdiction;

**Now Therefore** be it enacted by the Council of the Corporation of the Town of Petawawa as follows:

1. That By-law 1597/23, being a by-law to regulate and govern the operation of All-Terrain, Multi-Purpose and Recreational Off-Road Vehicles (ORVs) on highways under the jurisdiction of the Corporation of the Town of Petawawa, be amended as follows:

- 1.1 That the following be inserted as the new Section 3.10:

“3.10 Algonquin Trail Off-Road Vehicle Access Route

- 3.10.1 No person shall operate an Off-Road Vehicle on a Highway to access the Algonquin Trail from their place of residence, except on a designated route as described in Appendix “C” attached hereto.
- 3.10.2 No person shall operate an Off-Road Vehicle on a Highway to access their place of residence from the Algonquin Trail, except on a designated route as described in Appendix “C” attached hereto.
- 3.10.3 Residents are expected to take the shortest most direct route to access the Algonquin Trail from their place of residence and to return to their place of residence from the Algonquin Trail.
- 3.10.4 It is an offence to operate an Off-Road Vehicle on the Algonquin Trail Off-Road Vehicle Access Route if the destination of the Off-Road Vehicle is other than the operator’s/person’s place of residence or the Algonquin Trail.
- 3.10.5 No person shall operate an Off-Road Vehicle on the Algonquin Trail Off-Road Vehicle Access Route unless the person resides on the route, or the person is travelling in the same Off-Road Vehicle with a person who resides on the route.”

- 1.2 That the previous Section 3.10 be re-numbered to Section 3.11.

- 1.3 That the previous Section 3.11 be re-numbered to Section 3.12.

- 1.4 That the previous Section 3.12 be re-numbered to Section 3.13, and the previous Sub-Sections 3.12.1 to 3.12.5 be renumbered to Sub-Sections 3.13.1 to 3.13.5.

- 1.5 That the previous Section 3.13 be re-numbered to Section 3.14.

- 1.6 That the following be inserted as the new Section 5.4:

“5.4 That Appendix “C”, Algonquin Trail Off-Road Vehicle Access Route, attached hereto, is deemed to form part of this by-law.”

1.7 That the previous Section 5.4 be re-numbered to Section 5.5.

1.8 That the previous Section 5.5 be re-numbered to Section 5.6.

1.9 That Appendix “A” to By-law 1597/23, Town of Petawawa Designated Routes, be amended by deleting therefrom “Section 3.4” and replacing with “Section 3.8” thereto.

1.10 That Appendix “B” to By-law 1597/23, County of Renfrew Designated Routes, be amended by deleting therefrom “Section 3.5” and replacing with “Section 3.9” thereto.

1.11 That Appendix “C”, Algonquin Trail Off-Road Vehicle Access Route, attached hereto, be inserted as the new Appendix “C” to By-law 1597/23 and shall form part of By-law 1597/23.

2. That this by-law shall come into force and take effect following third reading.

By-law read a first and second time this 3<sup>rd</sup> day of June 2024.

By-law read a third time and passed this 3<sup>rd</sup> day of June 2024.

*"Original Signed"*

Signature of the Mayor

*"Original Signed"*

Signature of the Clerk

**Appendix “C” to By-law 1597/23  
adopted by By-law 1664/24 on June 3, 2024**

**Algonquin Trail Off-Road Vehicle Access Route**

**As per Section 3.10, below is a description and five (5) maps of the designated routes that Off-Road Vehicles are permitted to travel on within the Corporation of the Town of Petawawa and the County of Renfrew to access the Algonquin Trail.**

**\*\*Residents are expected to take the shortest most direct route to access the Algonquin Trail and to return to their place of residence from the Algonquin Trail. It is an offence to operate an Off-Road Vehicle on the Algonquin Trail Off-Road Vehicle Access Route if the destination of the Off-Road Vehicle is other than the operator’s/person’s place of residence or the Algonquin Trail.\*\***

- Hoffman Street;
- Labine Crescent;
- New Street;
- Poplar Street; and
- Victor Street.

**\*\*The residents of the above-noted streets are to access the Algonquin Trail via New Street.**

- Charles Street;
- Elmer Avenue;
- 93 Laurentian Drive to 333 Laurentian Drive;
- Michael Crescent;
- Mueller Crescent;
- Peppertree Drive;
- Peter Street;
- Ravenwood Crescent;
- Silkie Drive;
- Sunset Crescent; and
- William Street.

**\*\*The residents of the above-noted streets are to access the Algonquin Trail via Gutzman Road/Petawawa Boulevard/Black Bay Road intersection or Laurentian Drive/Petawawa Boulevard intersection.**

- Arrowhead Road;
- Chippewa Road;
- Country Lane;
- Gutzman Road;

- Heritage Drive;
- Isabel Street;
- Kramer Avenue;
- 18 Laurentian Drive to 91 Laurentian Drive;
- McKay Street;
- Oelke Street;
- Sack Road;
- Sandy Drive;
- Schwanz Road;
- Selley Street;
- Viking Road; and
- White Street.

**\*\*The residents of the above-noted streets are to access the Algonquin Trail via Gutzman Road/Petawawa Boulevard/Black Bay Road intersection or Laurentian Drive/Petawawa Boulevard intersection.**

- Airport Road;
- Anne Street;
- Behnke Crescent;
- Biesenthal Road;
- Birch Street;
- Dennis Crescent;
- Doris Street;
- Elton Street;
- Garwin Street (portion north-east of Petawawa Boulevard only);
- George Street;
- Kohut Drive;
- Pine Street;
- Pineridge Crescent;
- Radtke Road;
- River Drive;
- Runge Drive;
- Sharon Street (portion north-east of Petawawa Boulevard only);
- Southshore Drive; and
- Sylvan Drive.

**\*\*The residents of the above-noted streets are to access the Algonquin Trail via Radtke Road/Petawawa Boulevard/Airport Road intersection or Biesenthal Road.**

- Achray Road;
- Brumm Road;
- Centre Street;
- Doran Road (portion between Evergreen Drive and Achray Road only);
- Easy Street;
- Evergreen Drive;
- Fairway Drive;
- First Avenue;
- Golf Course Road;
- Lakeview Avenue;
- McGuire Street;
- Pinegrove Crescent;
- Risto Road;
- Ruth Street; and
- Springhill Crescent.

**\*\*The residents of the above-noted streets are to access the Algonquin Trail via Achray Road or Biesenthal Road or Airport Road (via Biesenthal Road).**

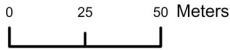
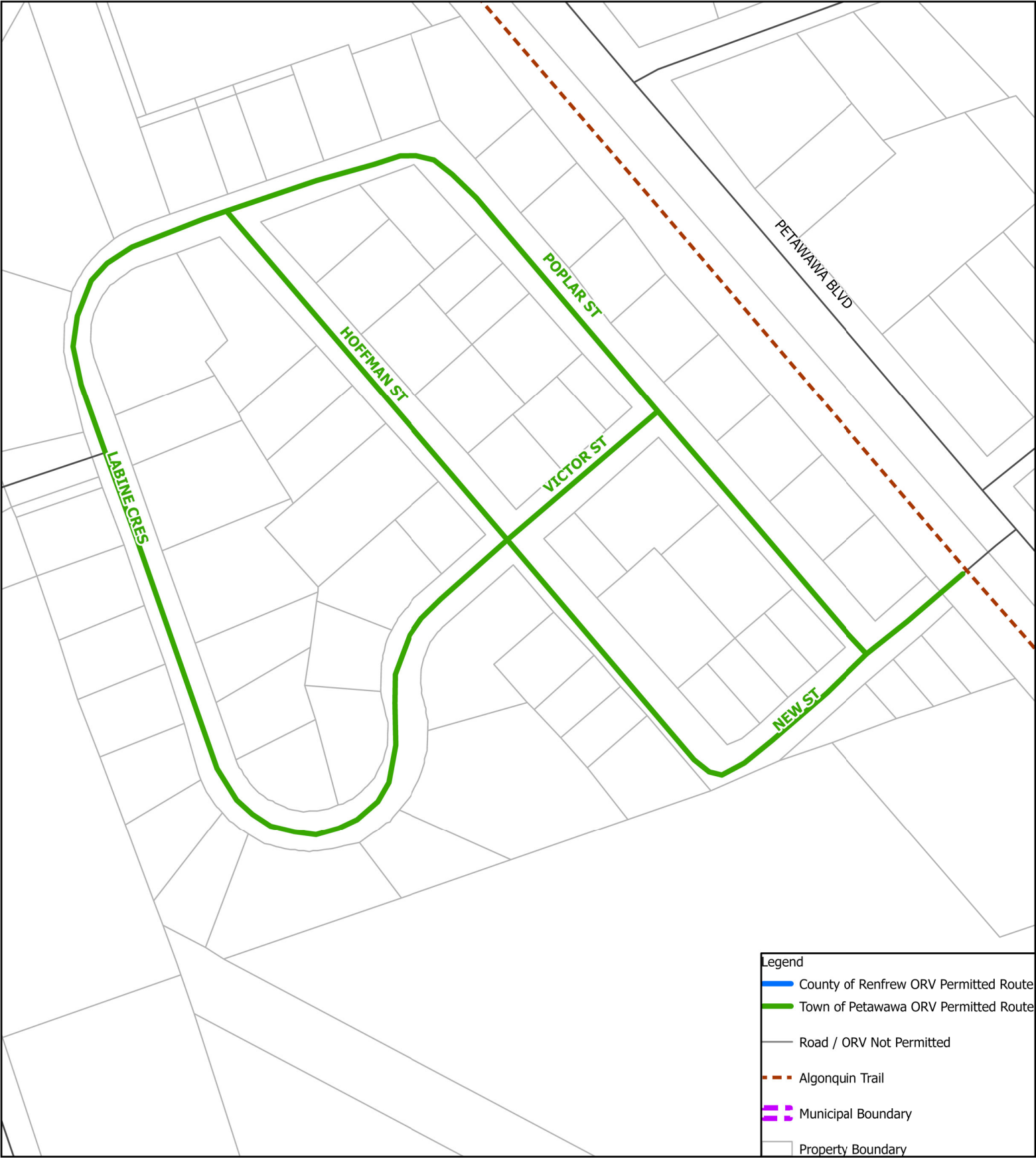

Town of Petawawa, Public Works Dept  
Map Publication: 2024-05-29 11:51 AM

Disclaimer: This map is a visual representation of the associated by-law and shall not supersede by-law requirements.



Appendix "C"  
Algonquin Trail Off-Road Vehicle Access Route  
via New St



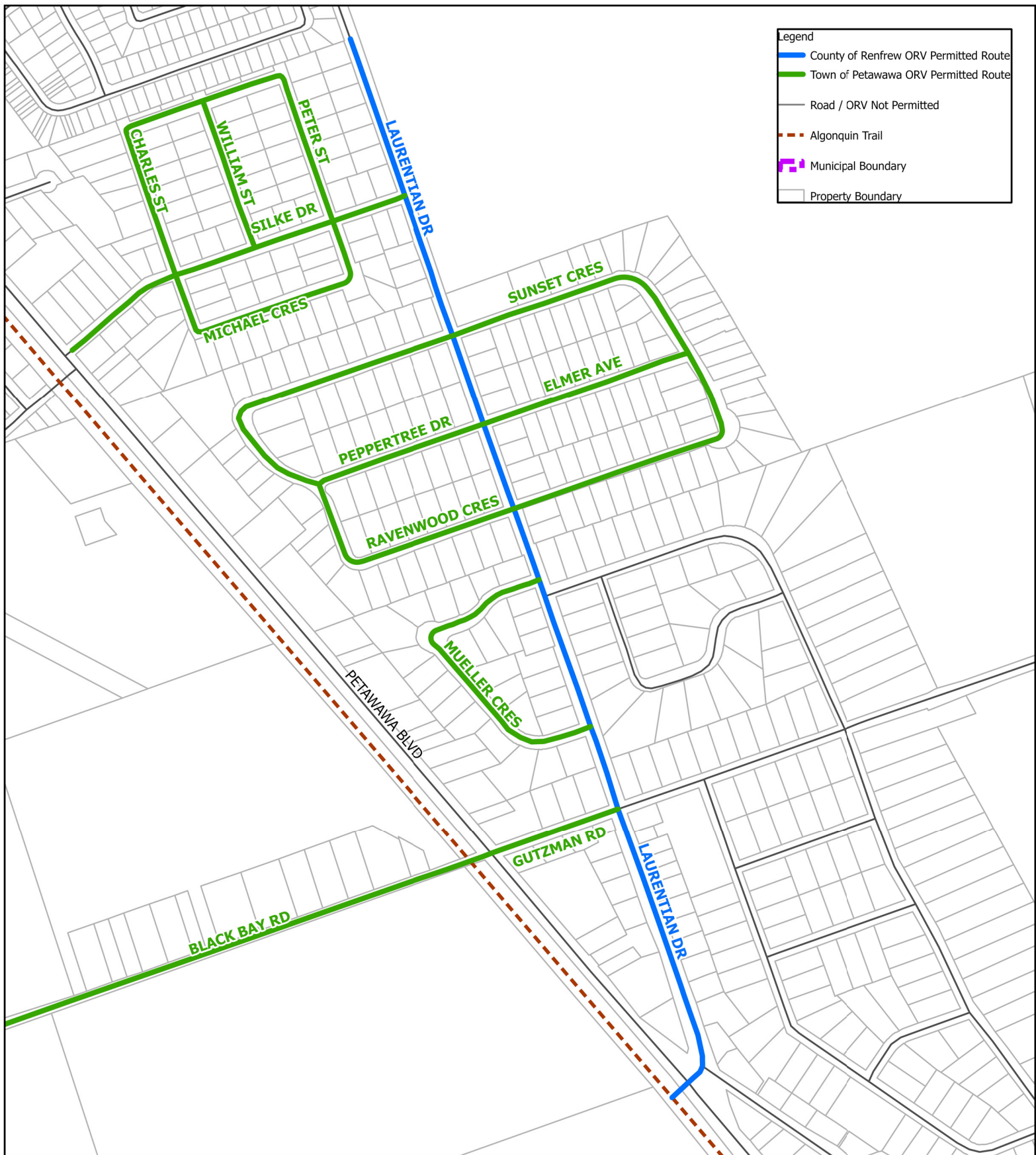

0 75 150 Meters

Appendix "C"  
Algonquin Trail Off-Road Vehicle Access Route  
via Gutzman Rd/Petawawa Blvd/Black Bay Rd or Laurentian Dr/Petawawa Blvd

Town of Petawawa, Public Works Dept  
Map Publication: 2024-05-29 11:57 AM

Disclaimer: This map is a visual representation of the associated by-law and shall not supersede by-law requirements.





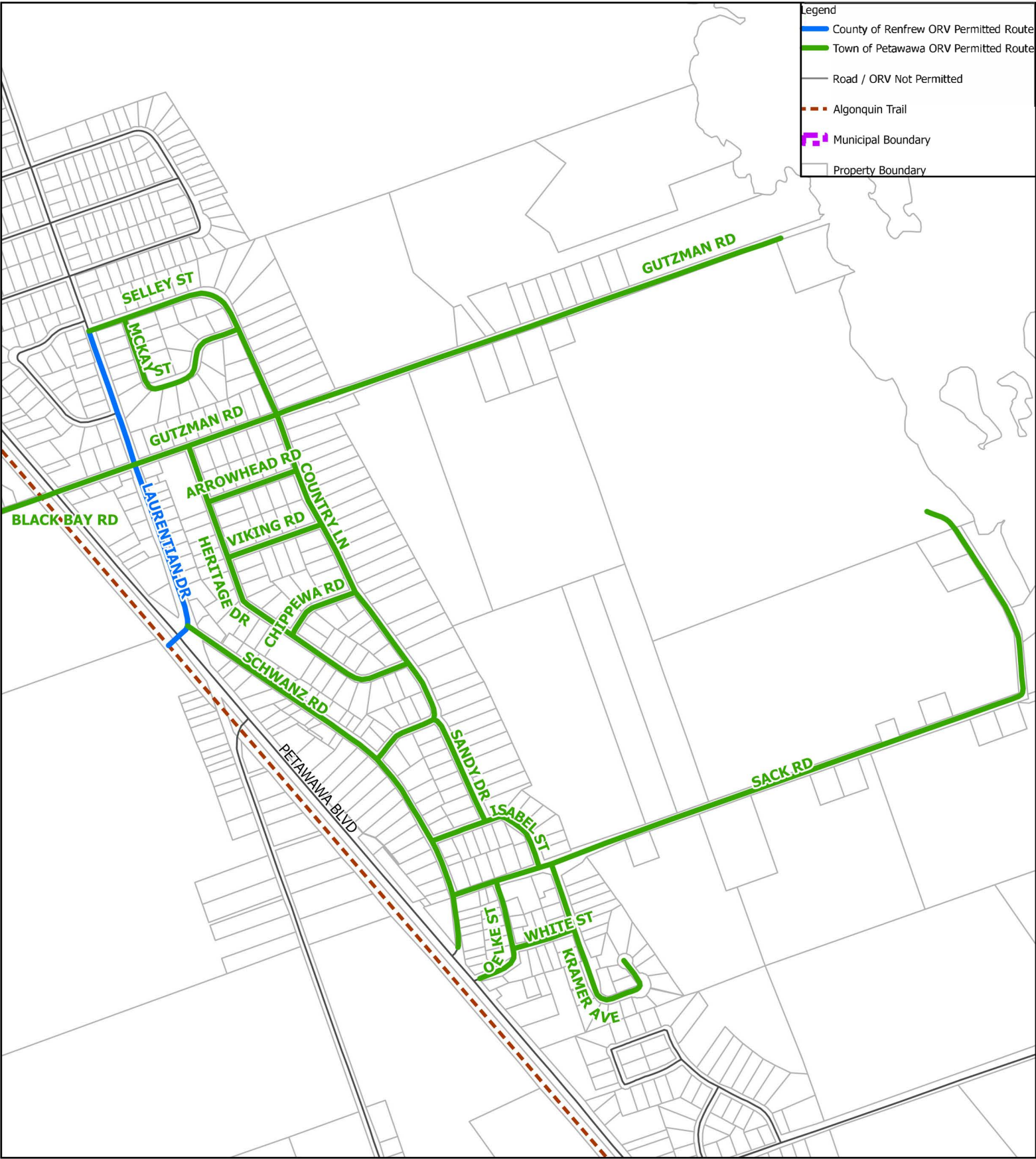

0 100 200 Meters

Town of Petawawa, Public Works Dept  
Map Publication: 2024-05-29 12:09 PM

Disclaimer: This map is a visual representation of the associated by-law and shall not supersede by-law requirements.



Appendix "C"  
Algonquin Trail Off-Road Vehicle Access Route  
via Gutzman Rd/Petawawa Blvd/Black Bay Rd or Laurentian Dr/Petawawa Blvd

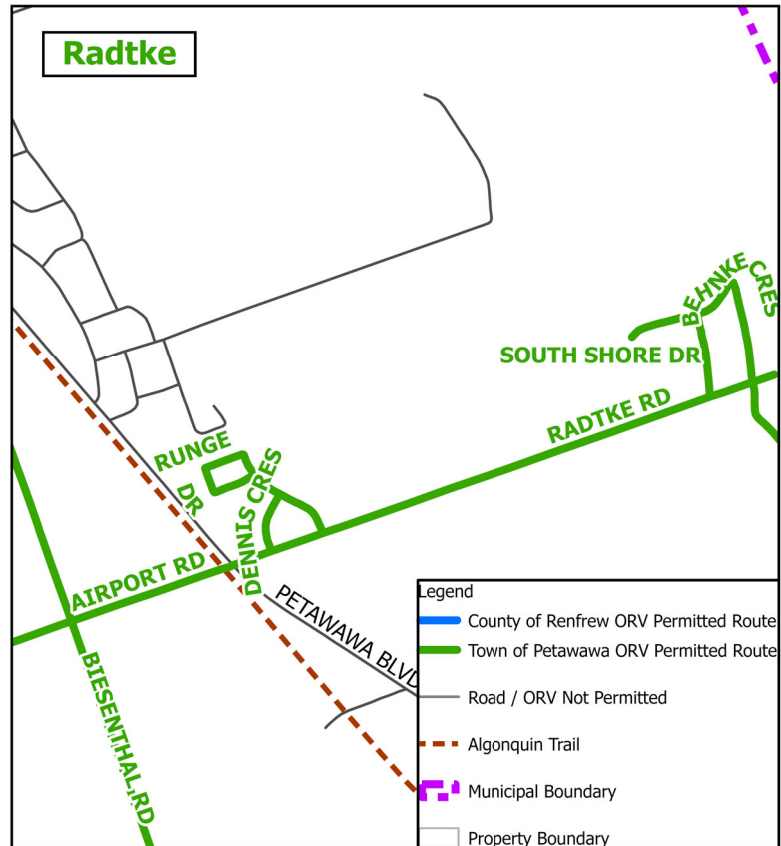
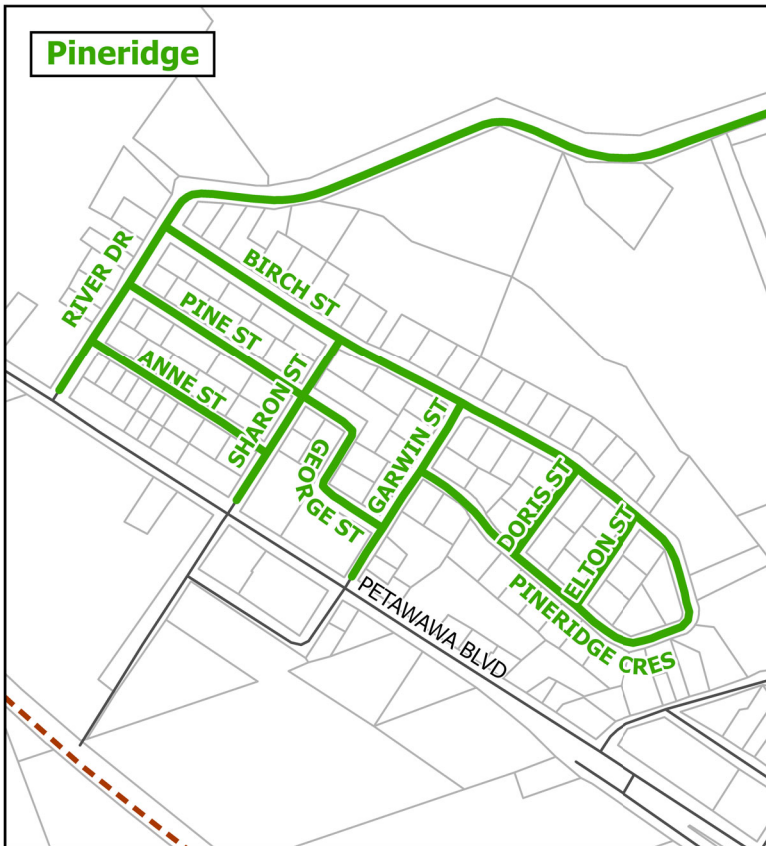
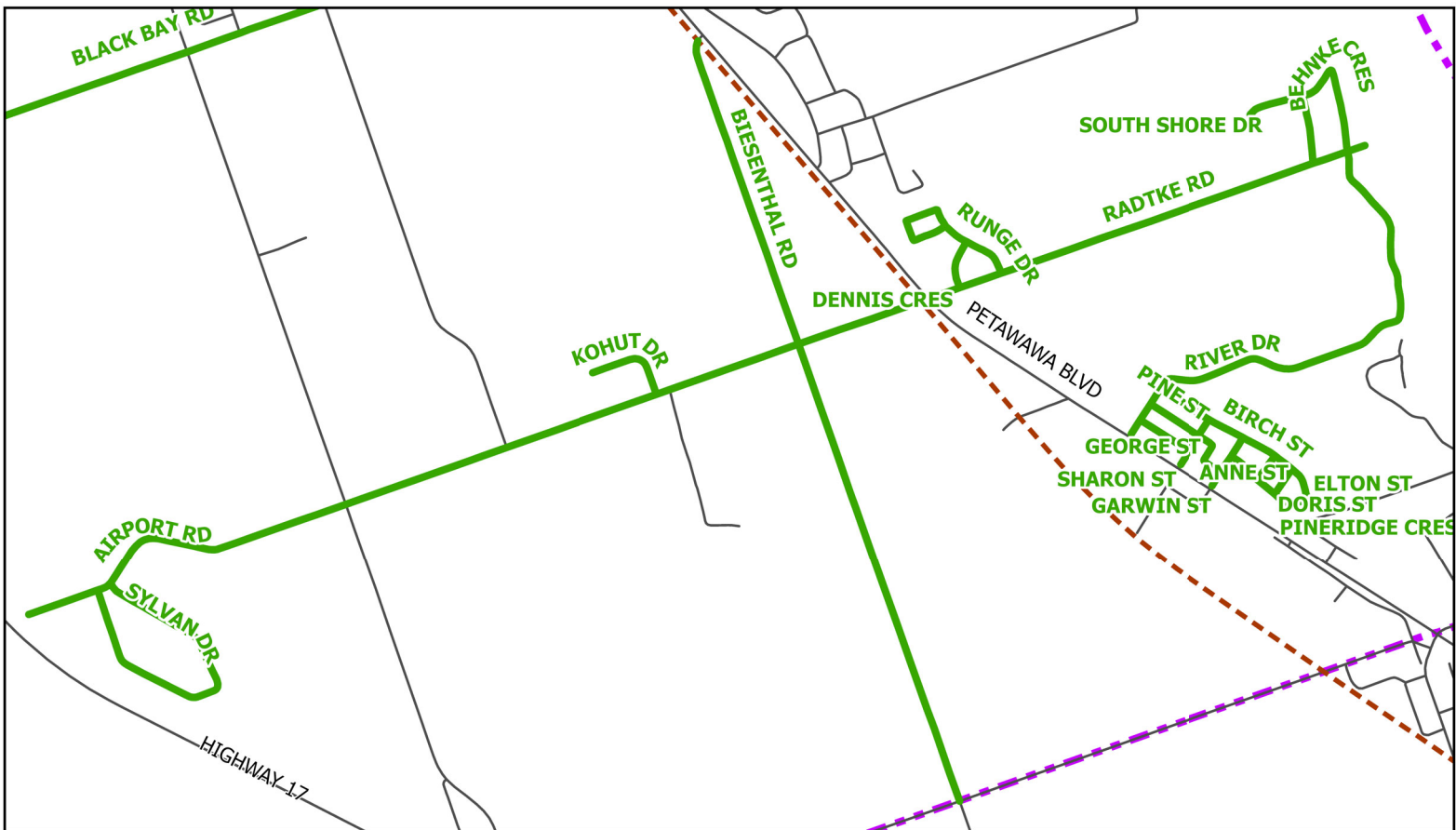

- Legend
- County of Renfrew ORV Permitted Route
  - Town of Petawawa ORV Permitted Route
  - Road / ORV Not Permitted
  - - - Algonquin Trail
  - - - Municipal Boundary
  - Property Boundary

0 100 200 Meters

Appendix "C"  
Algonquin Trail Off-Road Vehicle Access Route  
via Radtke Rd/Petawawa Blvd/Airport Rd or Biesenthal Rd

Town of Petawawa, Public Works Dept  
Map Publication: 2024-05-29 12:46 PM

Disclaimer: This map is a visual representation of the associated by-law and shall not supersede by-law requirements.





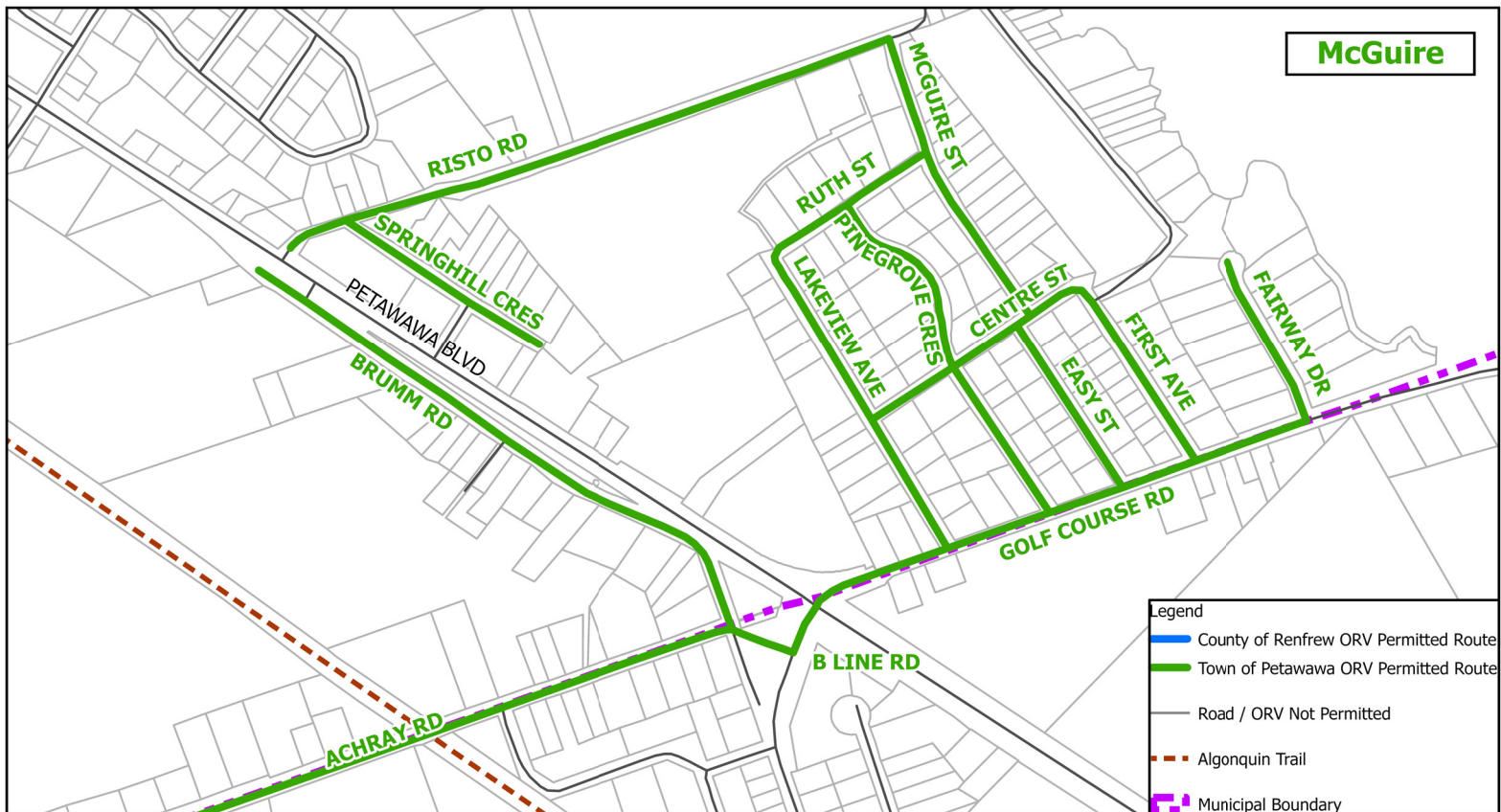
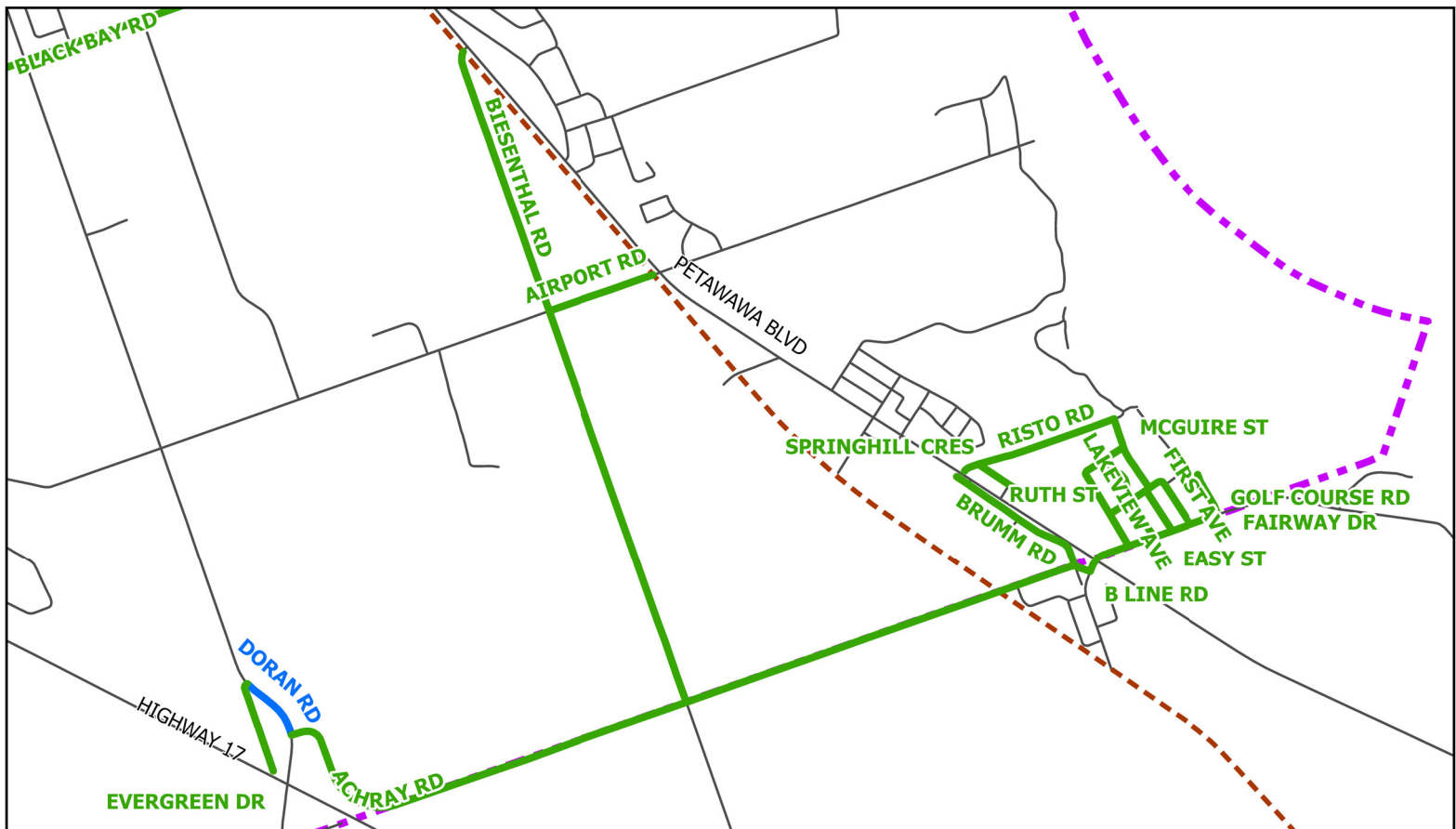

Appendix "C"  
Algonquin Trail Off-Road Vehicle Access Route  
via Achray Rd or Biesenthal Rd or Airport Rd (via Biesenthal Rd)

Town of Petawawa, Public Works Dept  
Map Publication: 2024-05-29 2:22 PM

Disclaimer: This map is a visual representation of the associated by-law and shall not supersede by-law requirements.

