

Town of Petawawa, Public Works Dept
Map Publication: 2024-05-29 11:51 AM

Disclaimer: This map is a visual representation of the associated by-law and shall not supersede by-law requirements.



Appendix "C"
Algonquin Trail Off-Road Vehicle Access Route
via New St



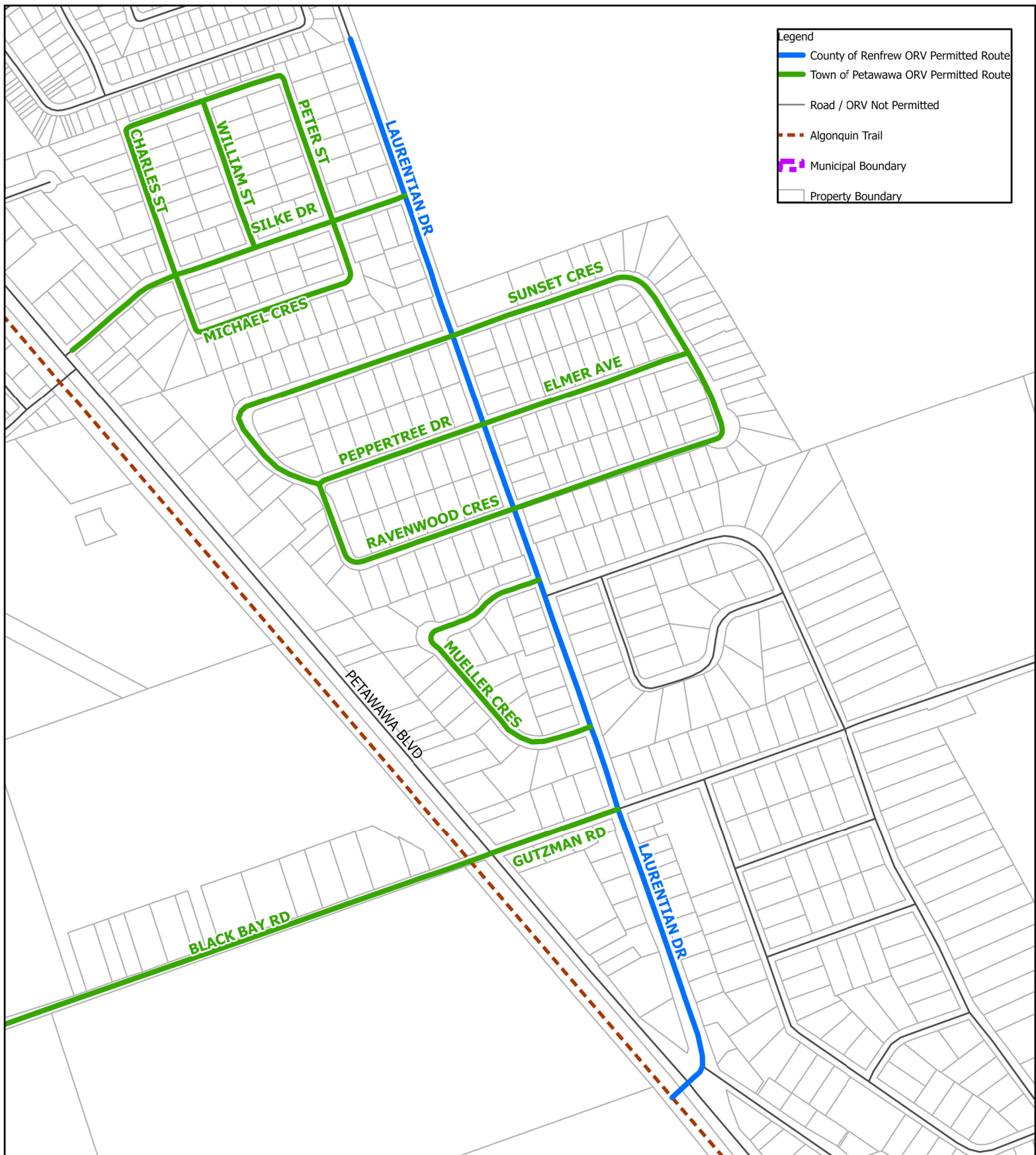

0 75 150 Meters

Appendix "C"
Algonquin Trail Off-Road Vehicle Access Route
via Gutzman Rd/Petawawa Blvd/Black Bay Rd or Laurentian Dr/Petawawa Blvd

Town of Petawawa, Public Works Dept
Map Publication: 2024-05-29 11:57 AM

Disclaimer: This map is a visual representation of the associated by-law and shall not supersede by-law requirements.



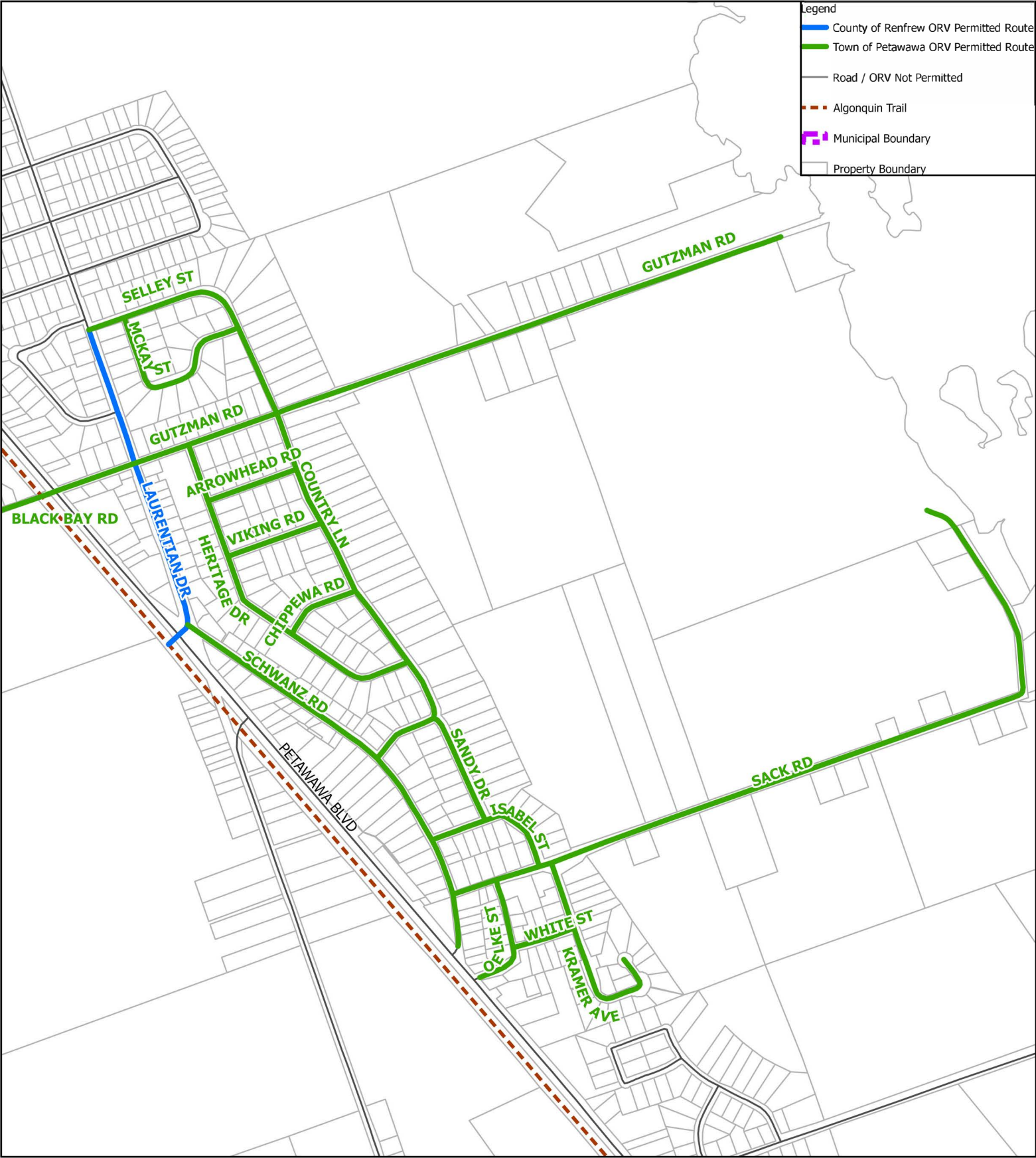

0 100 200 Meters

Town of Petawawa, Public Works Dept
Map Publication: 2024-05-29 12:09 PM

Disclaimer: This map is a visual representation of the associated by-law and shall not supersede by-law requirements.



Appendix "C"
Algonquin Trail Off-Road Vehicle Access Route
via Gutzman Rd/Petawawa Blvd/Black Bay Rd or Laurentian Dr/Petawawa Blvd

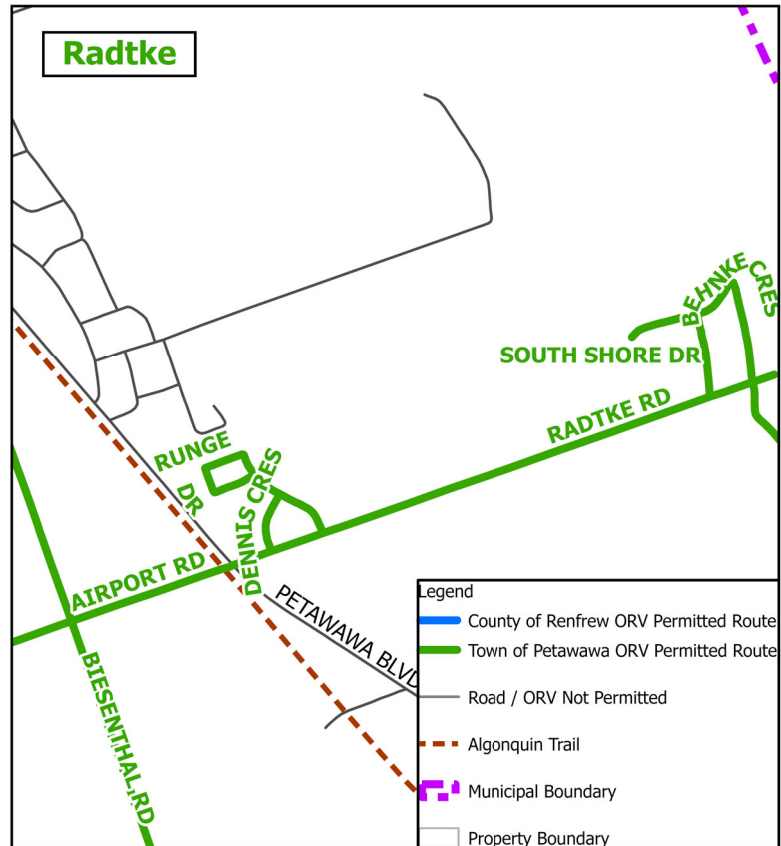
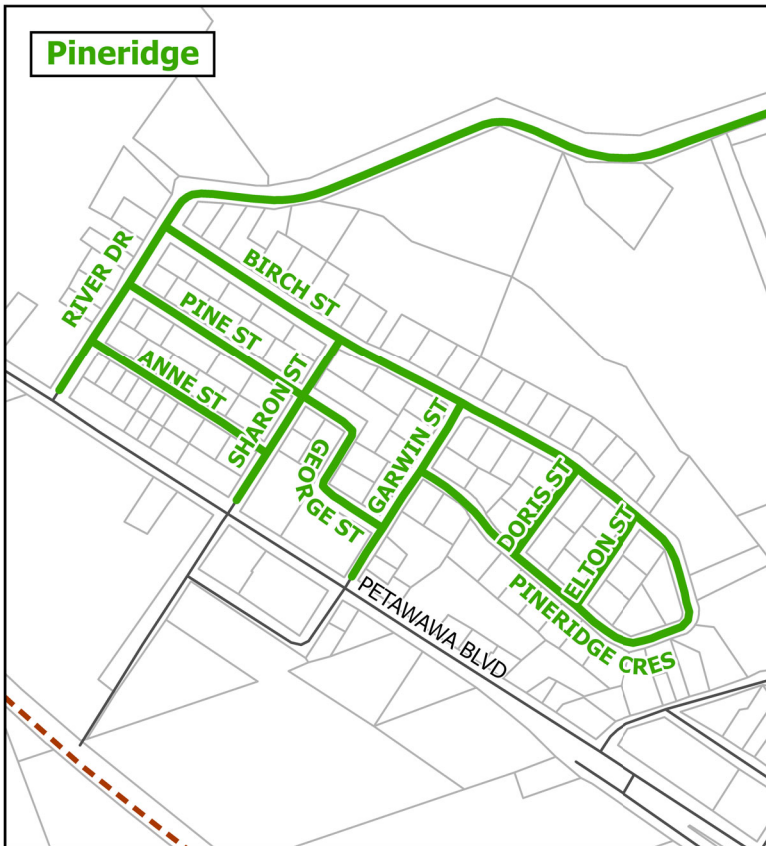
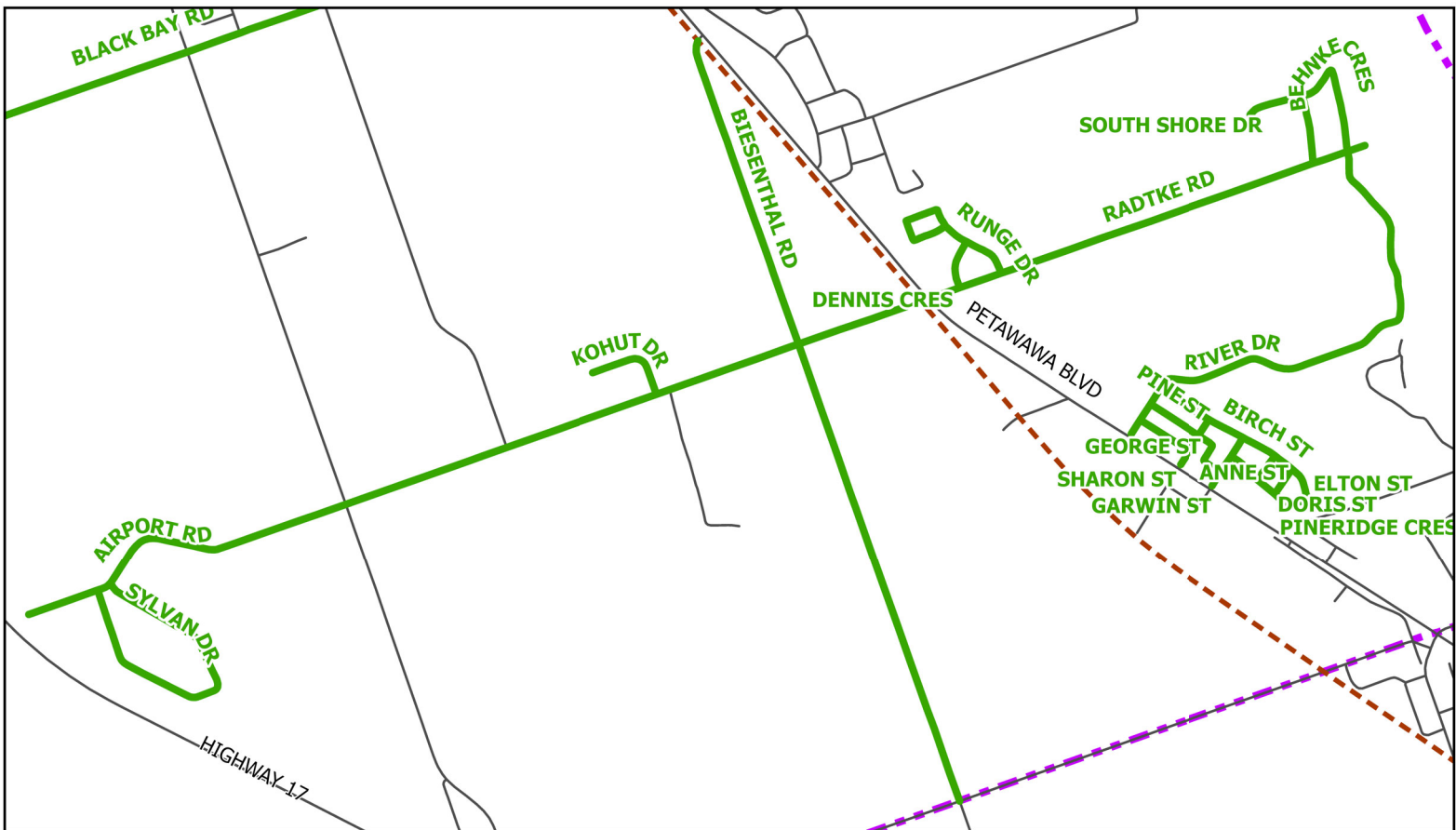

- Legend
- County of Renfrew ORV Permitted Route
 - Town of Petawawa ORV Permitted Route
 - Road / ORV Not Permitted
 - - - Algonquin Trail
 - - - Municipal Boundary
 - Property Boundary

0 100 200 Meters

Appendix "C"
Algonquin Trail Off-Road Vehicle Access Route
via Radtke Rd/Petawawa Blvd/Airport Rd or Biesenthal Rd



Town of Petawawa, Public Works Dept
Map Publication: 2024-05-29 12:46 PM

Disclaimer: This map is a visual representation of the associated by-law and shall not supersede by-law requirements.



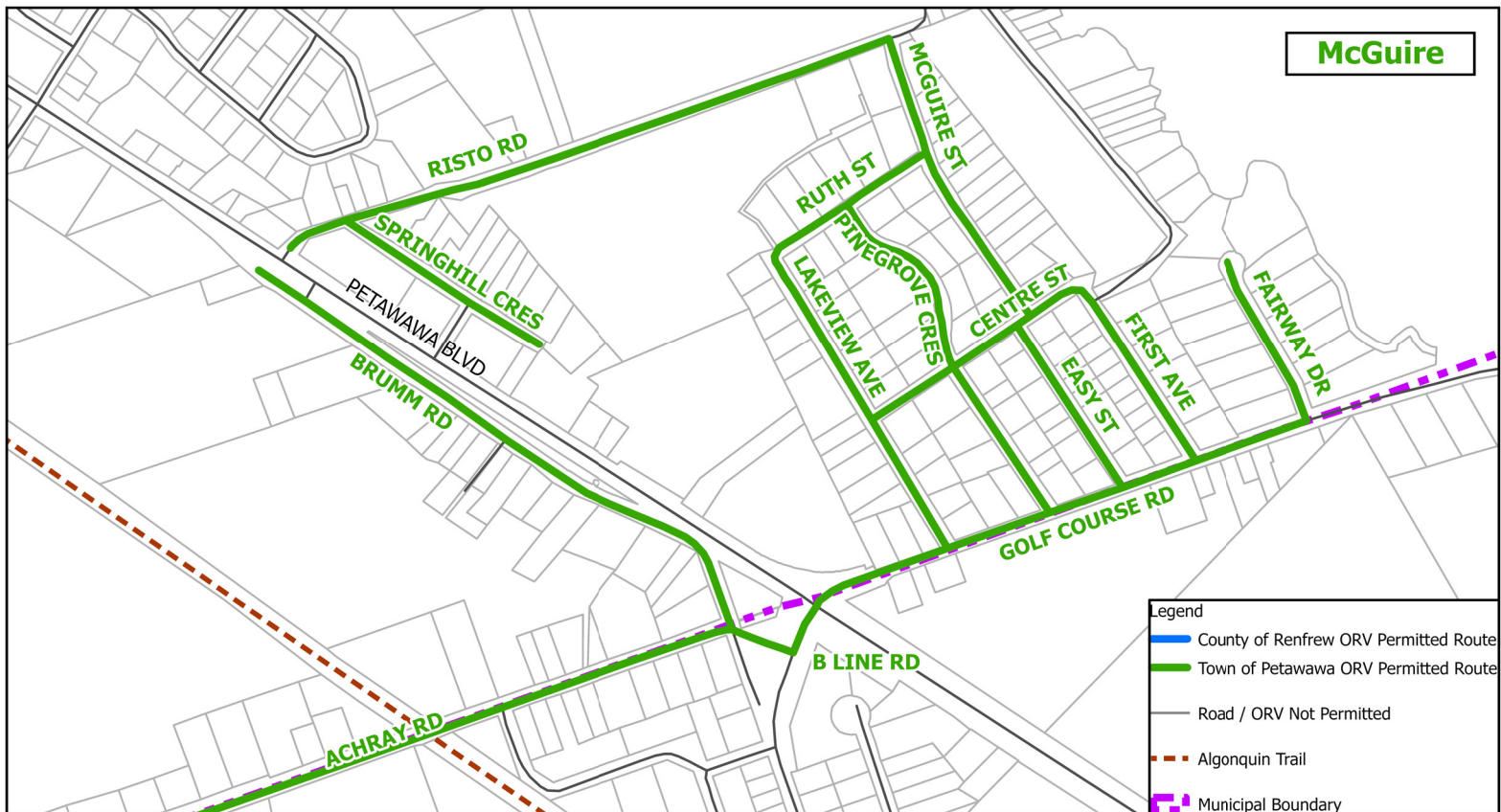
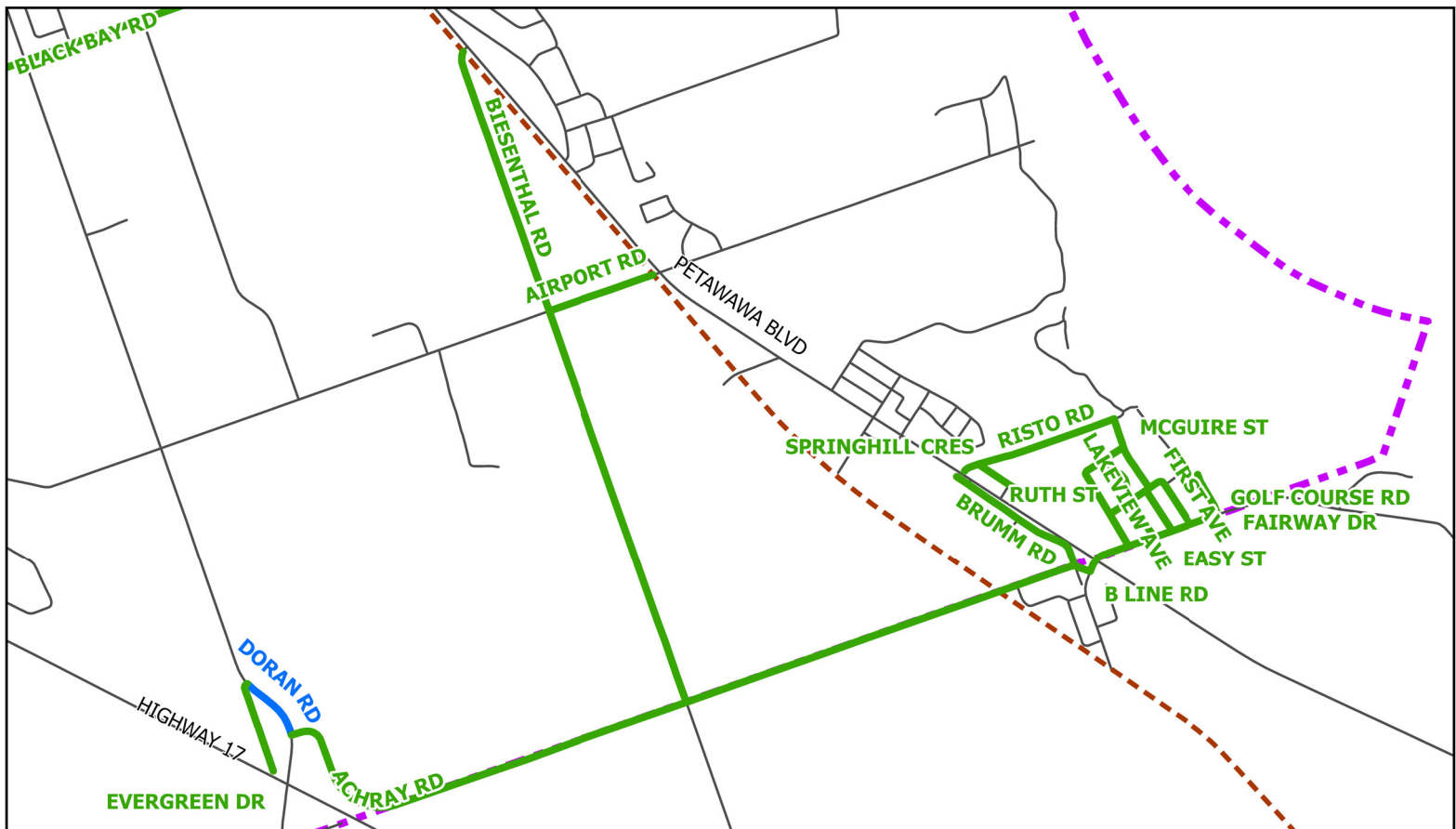

0 250 500 Meters

Appendix "C"
Algonquin Trail Off-Road Vehicle Access Route
via Achray Rd or Biesenthal Rd or Airport Rd (via Biesenthal Rd)

Town of Petawawa, Public Works Dept
Map Publication: 2024-05-29 2:22 PM

Disclaimer: This map is a visual representation of the associated by-law and shall not supersede by-law requirements.

